







🛏️ 2 Bedrooms | 🚪 1 Receptions | 🚿 1 Bathrooms | 📊 EPC Current C

Purpose Built Apartment – Bright and Spacious – Two Large Bedrooms – Reception Room – Modern Kitchen – Integrated Appliances – Ample Storage Space – Attractive Wooden Flooring – Swimming Pool – Tennis Court – Communal Gardens – Private Balcony - Off Street Parking.

This bright and spacious purpose built apartment is offered to the market furnished and is available mid/end August 2023. The property as a large reception room with a feature fireplace, a modern kitchen featuring integrated appliances, a master bedroom with built in wardrobes, a second double bedroom and a bathroom. Further benefits include ample storage space, a private balcony, off street parking, gas central heating and communal gardens, swimming pool and tennis court.

Ealing Village is in a great Ealing location. Ealing Broadway Station and North Ealing Station are within half a mile, giving it unparalleled transport links, and making it ideal for professionals commuting into and around Central London. Amenities are very easy to come by, with Ealing Broadway Shopping Centre just around the corner. The shops, bars and restaurants of the Broadway itself are very accessible, and because the tube stations are so close to the flat, the bright lights of Central London are just a tube ride away.

- Purpose Built Apartment
- Two Large Bedrooms
- Communal Gardens
- Holding Deposit: £415.00
- Long Term: 12-24 months+
- Bright and Spacious
- Reception Room
- Private Balcony
- Security Deposit: £2,076.92
- Council Tax Band: D

HELLIWELL & CO  
Approximate Gross Internal Area  
614 sq ft / 57.0 sq m

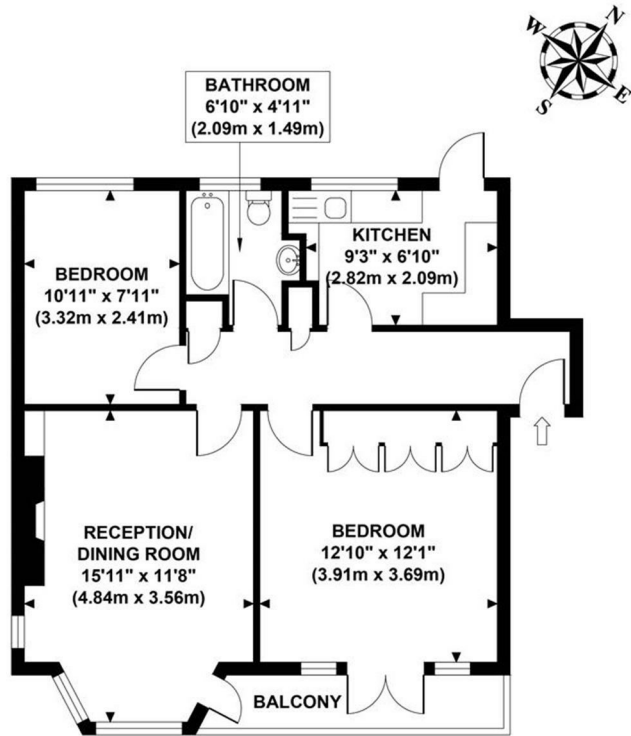

**GROSS INTERNAL  
FLOOR AREA 614 SQ FT**

Although every attempt has been made to ensure accuracy, all measurements are approximate and no responsibility is taken for any error, omission, or mid-statement. This floor plan is for illustrative purposes only and not to scale. Measured in accordance to RICS standards.

