







🛏️ 1 Bedrooms | 🛋️ 1 Receptions | 🚿 1 Bathrooms | 📊 EPC Current C

A spacious one-bedroom apartment offering bright and modern living space in a central location.

The property has a bright and airy living area with a modern kitchen featuring integrated appliances, a stylish bathroom and a separate sleeping area which is semi enclosed, offering privacy and space from the main open plan living area of the apartment. Further benefits include attractive wooden flooring and a neutral decor. Offered to the market unfurnished, the property is available now.

Birch Grove is conveniently located for access to both West Acton (Central line) and Acton Mainline stations, as well as Ealing Common (District and Piccadilly lines) and Ealing Broadway (Central and District lines, mainline and future Crossrail) stations (within a mile) - giving it unparalleled access to Central London and beyond. Amenities are very convenient for this property, including Ealing Broadways bustling shopping centre, as well as a range of bars, shops and restaurants and the beautiful open green spaces of Ealing Common.

- Bright and Spacious
- First Floor Studio
- Stylish Bathroom
- Unfurnished
- Long Term (12-24 months+)
- Modern and Trendy
- Integrated Appliances
- Semi Enclosed Sleeping Area
- Deposit: £1,557
- Council Tax Band B

HELLIWELL & CO.

BIRCH GROVE

Approximate Gross Internal Area
377 sq ft / 35.0 sq m

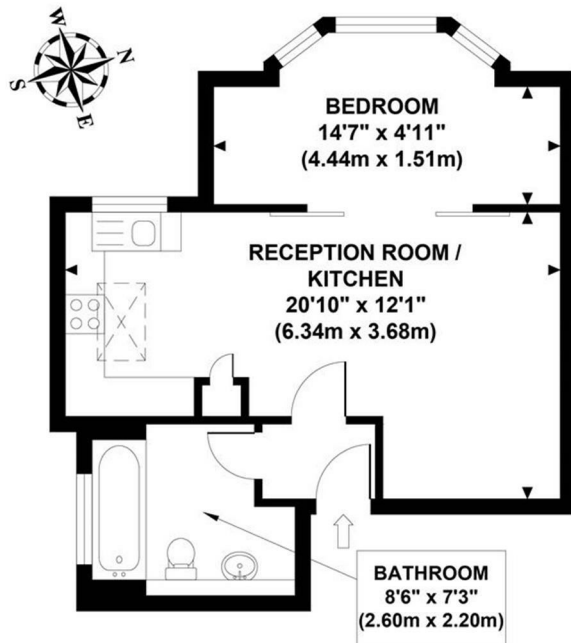

FIRST FLOOR
GROSS INTERNAL
FLOOR AREA 377 SQ FT

Although every attempt has been made to ensure accuracy, all measurements are approximate and no responsibility is taken for any error, omission, or mis-statement. This floor plan is for illustrative purposes only and not to scale. Measured in accordance to RICS standards.

