



HELLIWELL & CO  
ESTATE AGENTS

Westgate House, Ealing Road, TW8  
Offers In Excess Of £450,000





 2 Bedrooms |  1 Receptions |  1 Bathrooms |  EPC Current B

Helliwell & Co is proud to introduce this exclusive designer apartment in the most prestigious development in the Great West Quarter.

At well over 70 square meters, this expansive luxury flat offers impressive space and unparalleled natural light, and briefly comprises a generous open plan kitchen-reception area, two large bedrooms, modern bathroom and gorgeous winter balcony boasting dramatic, far-reaching views. Further benefits include gated, allocated underground parking, free residents gym, secure entry and award-winning hanging gardens.



Westgate House is a popular, pristine development nestled between Ealing and Kew Bridge, and provides excellent public transport links and easy access to the A4 / M4 for travel into and out of London.

- Stunning Designer Apartment
- Impressive Natural Light
- Beautiful Gardens & Winter Balcony
- Far-Reaching Views
- Underground Parking Included
- Free Residents Gym
- EPC Rating B
- Long Lease

**WESTGATE HOUSE**

Approximate Gross Internal Area  
845 sq ft / 78.50 sq m

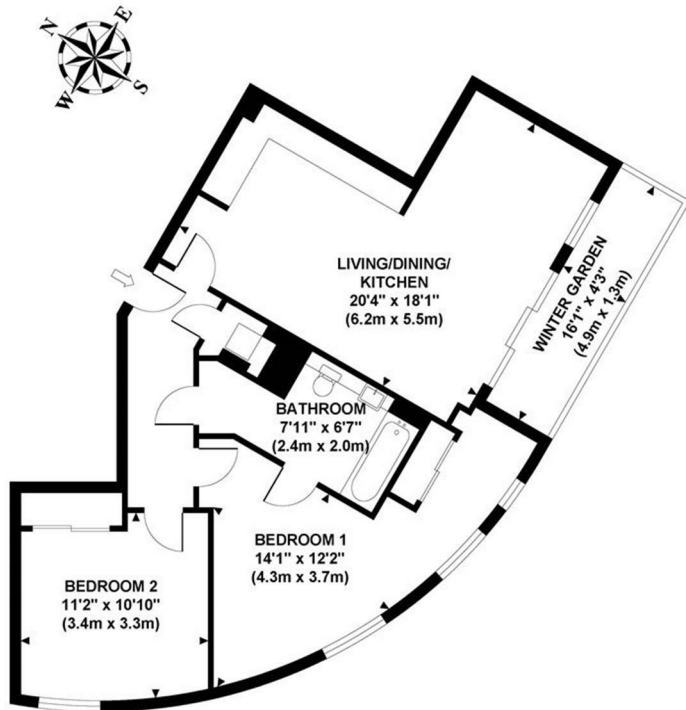

**GROSS INTERNAL  
FLOOR AREA 845 SQ FT**

Although every attempt has been made to ensure accuracy,  
all measurements are approximate and no responsibility is taken for any error, omission, or mid-statement.  
This floor plan is for illustrative purposes only and not to scale. Measured in accordance to RICS standards.

