











 1 Bedrooms |  1 Receptions |  1 Bathrooms |  EPC Current D

Purpose Built Development - Bright & Spacious Top Floor Flat - Large Double Bedroom - Separate Kitchen - Private Balcony - Communal Gardens - Off Street Parking - Garage - Furnished - Ample Storage Space.

Set within a well maintained, purpose-built building, this bright and modern top-floor apartment offers a spacious reception area with wooden flooring, a separate kitchen, a charming private balcony featuring lovely views and access to the manicured communal gardens. The property features a double bedroom with ample storage and a large modern bathroom with a rainfall shower, and further benefits from off-street parking and a private garage with storage space.

Wellesley Road is situated moments from the vibrant Chiswick High Road with its wonderful bars, restaurants and shops, and with easy access to Kew Bridge, Gunnersbury and Chiswick Park stations.

- Purpose Built
- Private Garage
- Balcony
- Holding Deposit: £380.00
- Long Term (12-24 months+)
- Semi Open Plan Living
- Off-Street Parking
- Communal Gardens
- Deposit: £1903.84
- Council Tax Band C



**WELLESLEY ROAD**

Approximate Gross Internal Area

443 sq ft / 41.20 sq m

Studio/Store/Garage Area 199 sq ft / 18.50 sq m

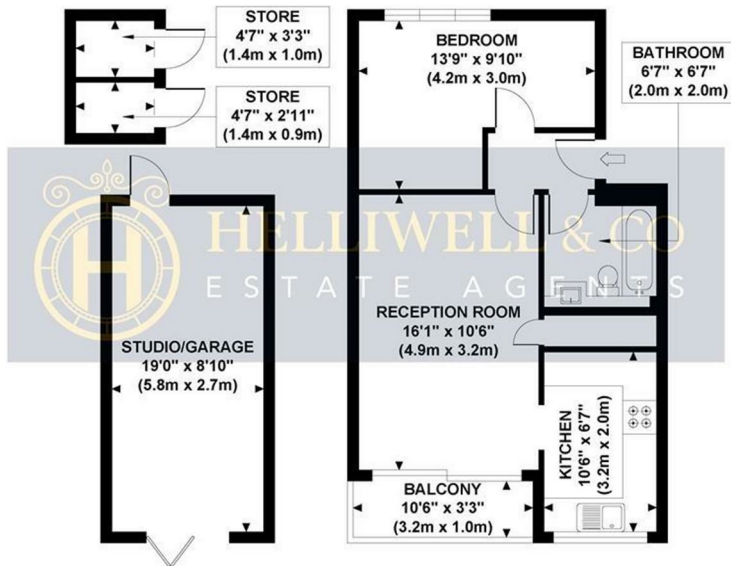

Although every attempt has been made to ensure accuracy, all measurements are approximate and no responsibility is taken for any error, omission, or mid-statement. This floor plan is for illustrative purposes only and not to scale. Measured in accordance to RICS standards.