







 3 Bedrooms |  1 Receptions |  2 Bathrooms |  EPC Current B

Brand New Development - Townhouse - Top of the Range Integrated Appliances - Three Bedrooms - Two Bathrooms & Additional WC - Private Garden - Off Street Parking - Available Now.

This bright and spacious, brand new Townhouse, is offered to the market unfurnished and is available now. Placed over three floors, the property has a large reception room, a separate modern kitchen featuring integrated appliances, three bedrooms, two bathrooms and an additional WC. Further benefits include a private garden, attractive wooden flooring with underfloor heating and off street parking.

Situated on a popular residential road, the property has numerous local shops, cafes and restaurants in the area, whilst also being ideally located for access to both Boston Manor (Piccadilly line) and Hanwell mainline stations. There are numerous open green spaces within the vicinity in addition to multiple transports links leading through to Ealing Broadway.

- Brand New Development
- Top of the Range Appliances
- Two Bathrooms & Additional WC
- Off Street Parking
- Deposit: £2884.61
- Townhouse
- Three Bedrooms
- Private Rear Garden
- Council Tax Band: TBC
- Long Term (12-24 months+)

WILMOT PLACE

Approximate Gross Internal Area
1142 sq ft / 106.1 sq m

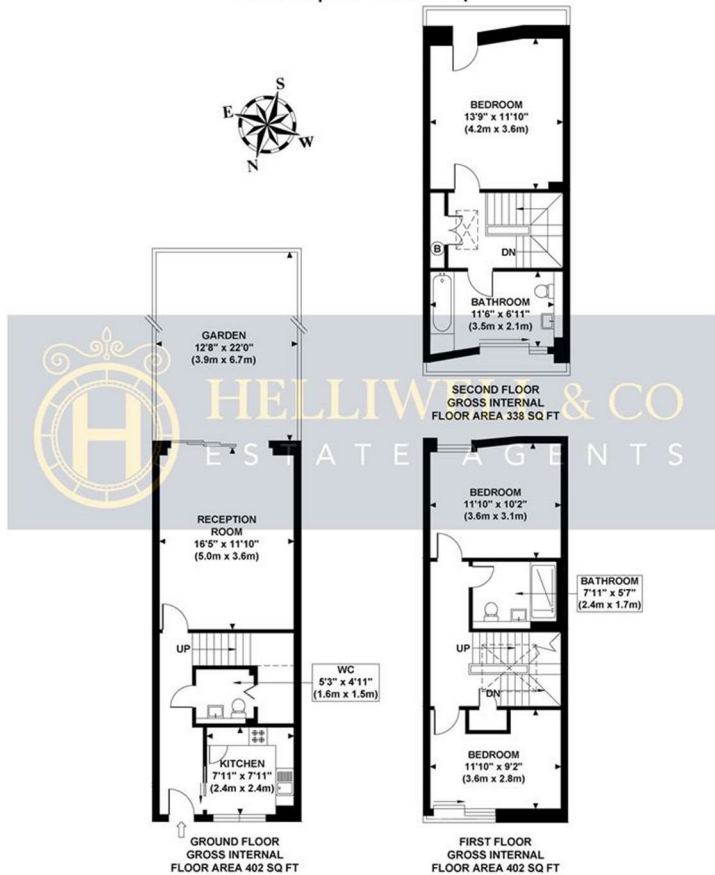

Although every attempt has been made to ensure accuracy, all measurements are approximate and no responsibility is taken for any error, omission, or mid-statement. This floor plan is for illustrative purposes only and not to scale. Measured in accordance to RICS standards.