



HELLIWELL & CO
ESTATE AGENTS

Broughton Road, Ealing, W13
£1,450 Per Calendar Month





 1 Bedrooms |  1 Receptions |  1 Bathrooms |  EPC Current D

Centrally Located – Single Professional or Couple - Ground Floor Flat – Well Presented - Double Bedroom – Private Rear Garden – West Ealing and Ealing Broadway Stations – Furnished - Available Early January 2023.

Ideal rental for a single professional or a couple. This well presented one double bedroom flat is placed on the ground floor of this corner plot property and offers plenty of natural light throughout. With beautiful wooden flooring the property has a spacious reception room with a charming bay window and French doors leading out to the private rear garden, a double bedroom, a semi open-plan kitchen with integrated appliances and a recently refurbished en suite bathroom. Offered to the market furnished and is available early January 2023.

Broughton Road is ideally located for access to West Ealing station (mainline and future Crossrail) and numerous local shops, restaurants and bars. Ealing Broadway's tube station (Central and District lines, mainline and future Crossrail) and shopping centre are located approximately 0.7 miles away.



- Centrally Located
- Ground Floor Flat
- Double Bedroom
- Available Early January 2023
- Council Tax Band: B
- Well Presented
- Single Professional or Couple
- Wooden Flooring
- Deposit: £1673.07
- Long Term: (12-24 months+)

HELLIWELL & CO.

BROUGHTON ROAD

Approximate Gross Internal Area
358 sq ft / 33.30 sq m

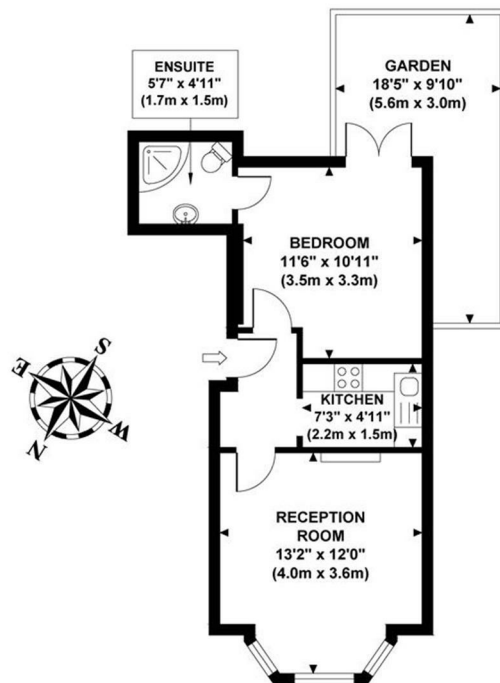

GROUND FLOOR
GROSS INTERNAL
FLOOR AREA 358 SQ FT

Although every attempt has been made to ensure accuracy,
all measurements are approximate and no responsibility is taken for any error, omission, or mid-statement.
This floor plan is for illustrative purposes only and not to scale. Measured in accordance to RICS standards.

