







 5 Bedrooms |  2 Receptions |  4 Bathrooms |  EPC Current E

Immaculate Condition – Terraced Family House – Placed Over Three Floors – Five Bedrooms – Four Bathrooms – Two Reception Rooms – Stylish Kitchen and Bathrooms – Unfurnished.

Offered to the market in fantastic condition, this bright and spacious terraced family house is placed over three floors and has approximately 2265sq.ft of living space. Entering through the receiving hallway, the property leads through to a double aspect reception room, a second open plan reception room with an impressive kitchen featuring integrated appliances, an island counter-space, space for dining and bi folding doors leading out to the private rear garden. The first floor has a master bedroom with built in wardrobes and private en suite which is equipped with a bathtub and separate power shower, two further bedrooms and a family bathroom, whilst the fourth and fifth bedrooms are located on the second floor, both of which have built in storage and private en suites. Further benefits include gas central heating, an attractive and neutral décor throughout, ample storage space and a basement. Offered unfurnished.

Maldon Road is located within the prestigious Poets Corner area of Acton and is walking distance from Acton Park and the popular Park Club as well as the shops, bars and restaurants along Churchfield Road and Acton High Street. There are numerous local schools in the area, in addition to the attractive open spaces of Springfield Gardens.

- Ideal Family Home
- Bright and Spacious
- Four Bathrooms
- Private Rear Garden
- Council Tax Band: G
- Attractive Terraced House
- Five Bedrooms
- Two Reception Rooms
- Deposit: £5192.30
- Long Let: (12 months+)

HELLIWELL & CO.

**MALDON ROAD**

Approximate Gross Internal Area 2265 sq ft / 210.40 sq m

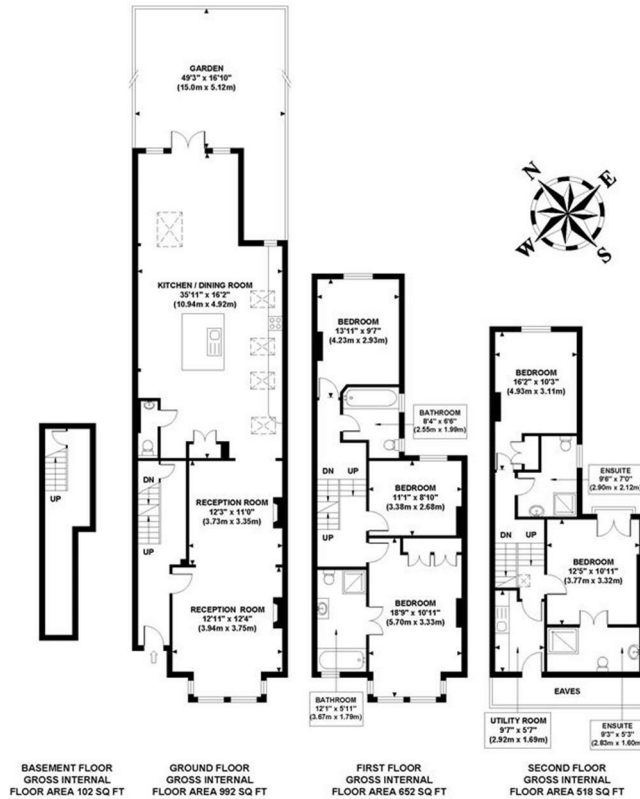

Although every attempt has been made to ensure accuracy, all measurements are approximate and no responsibility is taken for any error, omission, or mid-statement. This floor plan is for illustrative purposes only and not to scale. Measured in accordance to RICS standards.

