











 5 Bedrooms
 | 
  2 Receptions
 | 
  3 Bathrooms
 | 
  EPC Current D

Helliwell & Co is proud to exclusively present this staggeringly beautiful family home, situated on one of Ealing's most prestigious roads.

Whilst retaining the stunning, imposing, period architecture, this house has been meticulously redesigned and rebuilt by the current owner. The ground level is an expansive, serene paradise, with its beautiful wooden flooring, impressive high ceilings and light pouring in from the wonderful bay window, skylight and floor-to-ceiling rear doors, which lead out to a peaceful, meadow-like garden. The high quality kitchen offers excellent worktop space, a large range cooker and room for the all-important Christmas banquet table. This floor also benefits from plenty of storage, including a beautiful built-in bookcase, and a generous utility room and downstairs WC.

Winding up the gorgeous wooden stairs, the impressive first floor has been reconfigured to create a modern family bathroom and three large bedrooms, including an unparalleled master bedroom with enormous, high spec en-suite. The top floor briefly comprises a bright and airy double bedroom, contemporary shower room and finally a lovely reading room, perfect for a home office or guests. This level also benefits from multiple cleverly-designed light portals, unusually generous ceiling height and a huge amount of storage.

Sherborne Gardens is a highly sought-after, tree-lined street in the St Stephen's pocket of Ealing, moments from a variety of schools, all enjoying exemplary reputations, and benefitting from easy access to West Ealing Station (Crossrail & GWR) and Ealing Broadway (Crossrail, Central Line, District Line & GWR) as well as the abundance of parks, boutiques, cafes and restaurants on offer in central Ealing and the award-winning Pitshanger Village.

- Stunning Semi-Detached Period House
- Expansive Ground Floor
- Cleverly Redesigned & Remodelled
- Five Generous Bedrooms
- Charm and Character Throughout
- Three Bathrooms & Additional WC
- Over 2100 SQ FT
- Charming Meadow Garden



### SHERBORNE GARDENS

Approximate Gross Internal Area 1952 sq ft / 181.30 sq m

Eaves/Reduced Headroom Area 153 sq ft / 14.21 sq m

Total Area 2105 sq ft / 195.51 sq m

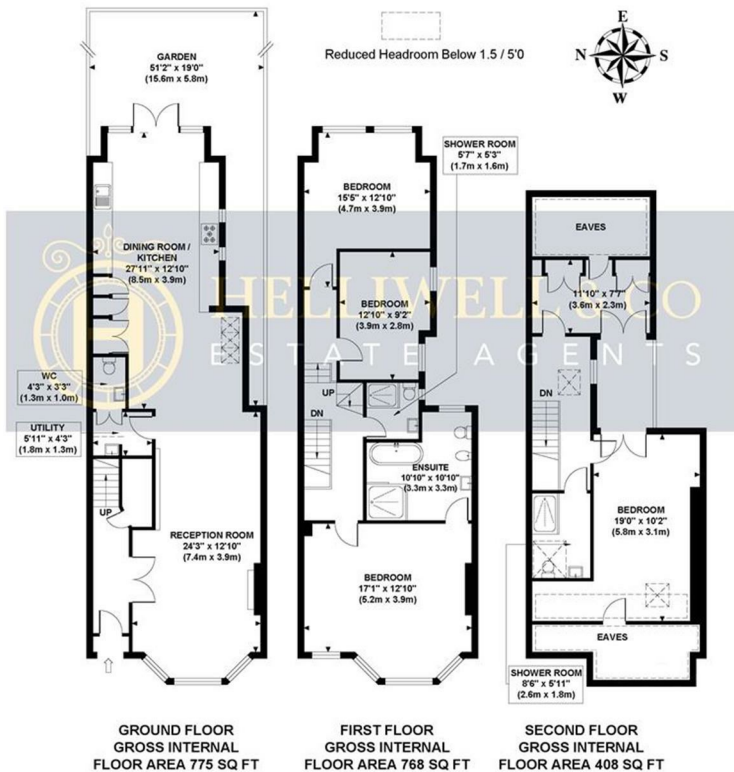

Although every attempt has been made to ensure accuracy, all measurements are approximate and no responsibility is taken for any error, omission, or mis-statement. This floor plan is for illustrative purposes only and not to scale. Measured in accordance to RICS standards.

