



HELLIWELL & CO  
ESTATE AGENTS

Brunner Road, Pitshanger Village,  
Guide Price ~~£1,000,000~~ £995,000





 3 Bedrooms |  2 Receptions |  1 Bathrooms |  EPC Current D

Helliwell & Co is proud to exclusively present a unique opportunity to acquire this stunning, iconic, turreted Edwardian corner plot, in the heart of the highly desirable Brentham Garden Suburb.

With its unparalleled, distinctive architecture, this house has been lovingly and painstakingly refurbished to a brilliant standard by the current owners, offering the perfect balance between period charm and high-spec contemporaneity. This wonderful home briefly comprises expansive through-lounge, modern separate kitchen with high-end appliances, three generous bedrooms, beautifully renovated bathroom with plenty of space and characterful fittings, huge loft storage, wide side access and beautiful lawned garden.

In the heart of the Brentham Conservation Area, steeped in history, the location is incredibly convenient for a variety of exceptional schools (including Montpelier, North Ealing, St Gregory's, St Benedict's, St Augustine's, Ada Lovelace and Notting Hill & Ealing) as well an abundance of parks and social opportunities in the award-winning Pitshanger Village, known for its fantastic selection of boutiques, cafes, restaurants and the popular Brentham Club. The buzzing centre of Ealing Broadway (Elizabeth Line, Central Line, District Line, Mainline and GWR) is easily reachable, offering excellent transport links and plenty of shops, bars and restaurants.

- Edwardian Corner Plot
- Distinctive Architecture
- Beautifully Refurbished
- Stunning Private Garden
- Council Tax Band: F
- Brentham Garden Suburb
- Heart of Pitshanger Village
- Exceptional Schools Nearby
- Freehold

**BRUNNER ROAD**

Approximate Gross Internal Area  
1028 sq ft / 95.5 sq m

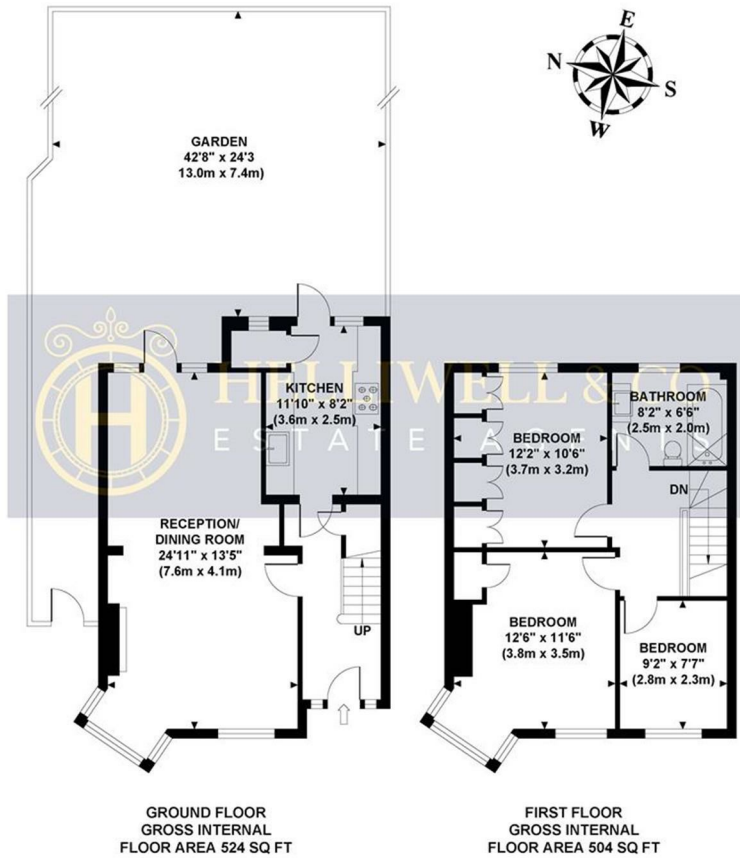

Although every attempt has been made to ensure accuracy,  
all measurements are approximate and no responsibility is taken for any error, omission, or mid-statement.  
This floor plan is for illustrative purposes only and not to scale. Measured in accordance to RICS standards.

