



HELLIWELL & CO
ESTATE AGENTS

Webster Gardens, Ealing, London
Guide Price £600,000





🛏️ 2 Bedrooms | 🛋️ 1 Receptions | 🚿 1 Bathrooms | 📊 EPC Current C

Helliwell & Co is proud to introduce this wonderful garden flat on one of Ealing's most desirable roads, with the added benefits of a private entrance and share of freehold.



- Stunning Garden Maisonette
- Set Within Beautiful Detached Building
- Prime W5 Location
- Fantastic Spec Throughout
- Share of Freehold
- Service Charge: N/A
- Council Tax: Band D
- Long Underlying Lease

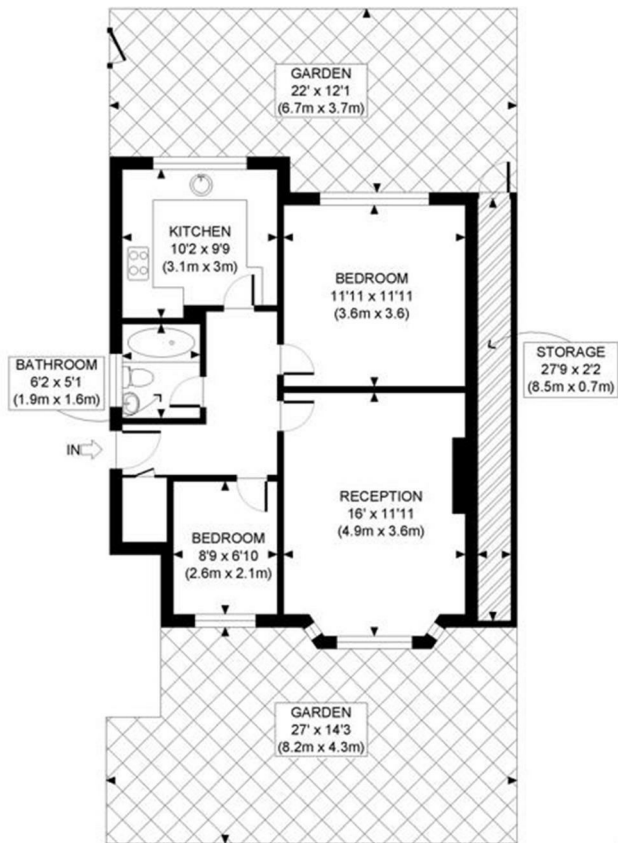

GROUND FLOOR
GROSS INTERNAL
FLOOR AREA 624 SQ FT

APPROX. GROSS INTERNAL FLOOR AREA: 624 SQ FT/ 58 SQM

