



HELLIWELL & CO
ESTATE AGENTS

St Marys Road, Ealing, London
Guide Price £400,000





 1 Bedrooms |  1 Receptions |  1 Bathrooms |  EPC Current C

Helliwell & Co is delighted to exclusively introduce this newly refurbished apartment, set within an attractive Georgian building in the heart of Olde Ealing, just a stone's throw from Walpole Park and Ealing Broadway.

With light pouring in from the elegant, double-glazed, timber sash windows, and benefitting from beautiful views of chimney pots and treetops, this fantastic apartment boasts 550 sq ft of living space, and briefly comprises an expansive open plan reception area complete with a brand new, high-spec kitchen, contemporary shower room, large double bedroom with high quality built-in wardrobes, and ample storage throughout. Further benefits include wooden flooring, state-of-the-art heating system, long lease and no onward chain.

Located on one of Ealing's finest tree-lined roads, this fantastic apartment is ideally situated for access to both Ealing Broadway (Elizabeth Line, Central Line, District Line & GWR) and South Ealing (Piccadilly Line) stations, the useful 65 bus route and the abundance of independent cafes, pubs, restaurants and shopping opportunities available in Olde Ealing and Ealing Broadway. The wonderful green spaces of Lammas Park and Walpole Park are within touching distance, perfect for picnics in the summer and brisk walks in the winter.

- Beautiful Georgian Building
- Newly Refurbished Apartment
- High-Spec Finish Throughout
- Service Charge: £550 P/A (Reviewed Annually)
- Leasehold: 150 Years Remaining
- Fantastic Ealing Broadway Location
- Circa 550 Sq Ft
- No Onward Chain
- Ground Rent: £200 P/A (Reviewed Every 10 Years)
- Council Tax Band: B

ST MARY'S ROAD

Approximate Gross Internal Area
550 sq ft / 51.10 sq m

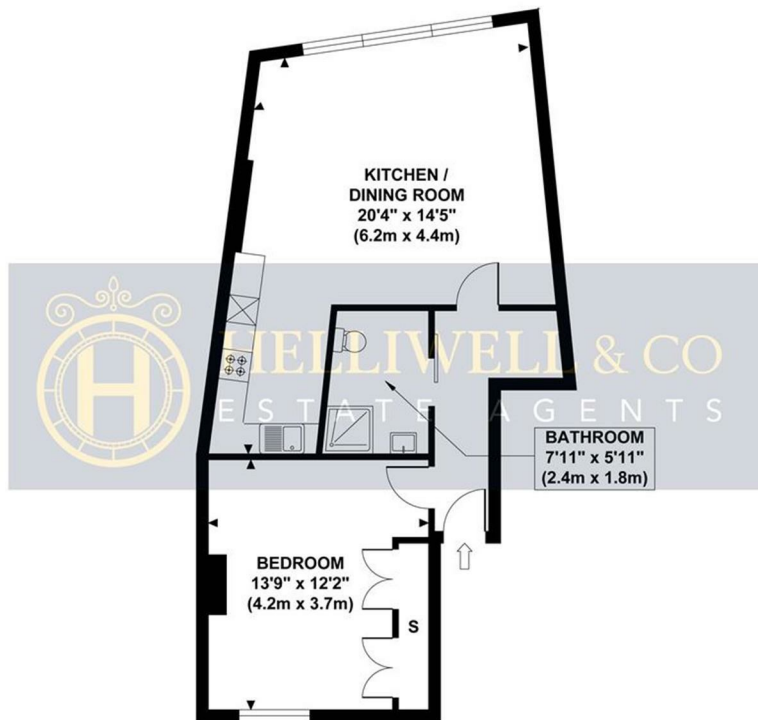

FIRST FLOOR
GROSS INTERNAL
FLOOR AREA 550 SQ FT



Although every attempt has been made to ensure accuracy, all measurements are approximate and no responsibility is taken for any error, omission, or mid-statement. This floor plan is for illustrative purposes only and not to scale. Measured in accordance to RICS standards.