







 2 Bedrooms |  1 Receptions |  1 Bathrooms |  EPC Current C

Helliwell & Co are proud to present one of four newly converted two bedroom luxury apartments available to the market. This two double bedroom, one bathroom property, with a balcony has been finished to the highest standard throughout with marble tiled bathrooms and bespoke fixtures and fittings. A beautiful herringbone oak floor has been fitted in the sitting and dining area with neutral décor and double-glazing throughout. In addition there is the bonus of air conditioning for cooling in summer and large amounts of eaves storage.

Rosebank Road is ideally located for access to both Hanwell Crossrail station and Boston Manor (Piccadilly line) tube station, as well as numerous local shops, cafes and restaurants in the area. There are numerous local schools in the area, including St. Joseph's Primary School and Elthorne Park High School, making it an ideal home for families. The Uxbridge Road provides multiple shopping facilities and bus routes into Ealing Broadway. Hanwell is a very green and scenic suburban area of Greater London, with the River Brent and the surrounding parklands making for several beautiful walks.

- Brand New Apartment
- One Bathroom
- South facing private Terrace
- Tenure: Share of Freehold
- Ground Rent: Nil
- Two Bedrooms
- Air Conditioning
- Parking
- Service Charge: Nil
- Council Tax Band:

ROSEBANK ROAD

Approximate Gross Internal Area 795 sq ft / 73.85 sq m

(Including Restricted Height Area)

Eaves Storage 82 sq ft / 7.62 sq m

Total 877 sq ft / 81.47 sq m

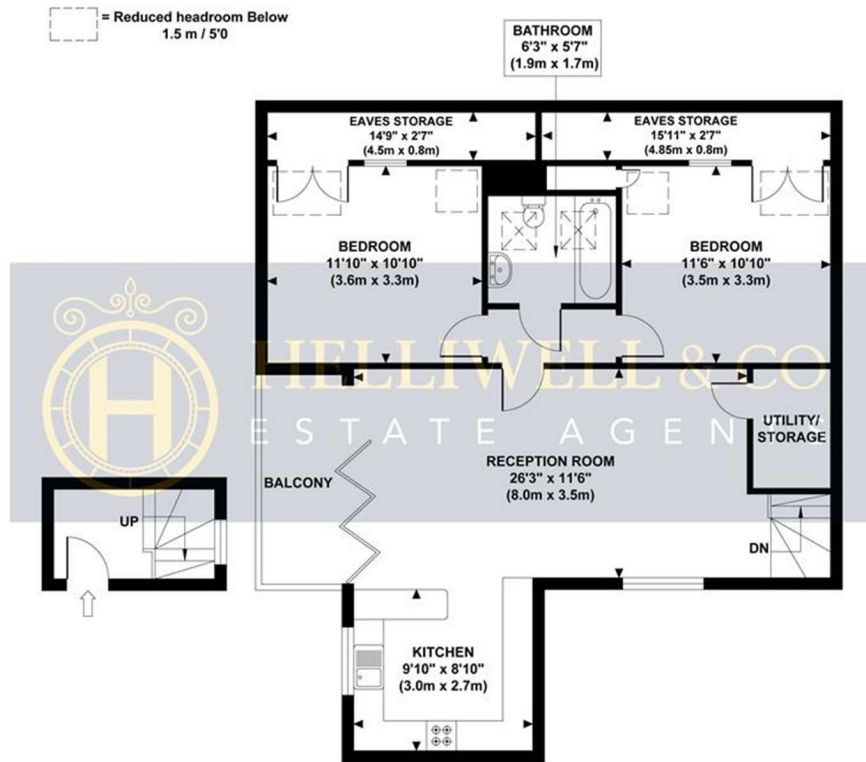

GROUND FLOOR
GROSS INTERNAL
FLOOR AREA 44 SQ FT

TOP FLOOR
GROSS INTERNAL
FLOOR AREA 751 SQ FT

