



HELLIWELL & CO
ESTATE AGENTS

Overdale Road, Ealing, W5
£3,700 Per Calendar Month





🛏 5 Bedrooms | 🛋 1 Receptions | 🚿 3 Bathrooms | 📊 EPC Current D

Terraced Family House - Five Bedrooms - Open Plan Living - Modern Integrated Appliances - Three Bathrooms - Private Gardens - Good Local Schools - Residential Location - Multiple Transport Links.

This bright and spacious, terraced family house, which is placed within a lovely and quaint neighbourhood, is offered to the market unfurnished and is available in early April 2024. Entering through the receiving hallway, the property has a double aspect reception room with attractive wooden floors, leading to a modern integrated kitchen which has direct access to a private rear garden. Upstairs are three bedrooms and a family bathroom, whilst a further two bedrooms, both with en suites are located on the top floor.

Overdale Road is located moments from Northfields Avenue where you will find a great selection of family run shops, restaurants, bars and local amenities including Lammas Park. Northfields tube station is also accessible where you have access to the Piccadilly line offering great services into and around Central London. Further transport links include the E2 and E3 buses, that take you straight to Ealing Broadway, alternatively you can take a beautiful walk through Walpole Park and you will have access to the vast array of shops and eateries Ealing has to offer.

- Terraced Family House
- Open Plan Living
- Three Bathrooms
- Holding Deposit (1 weeks rent): £853.00
- Long Let (12-24 months+)
- Five Bedrooms
- Modern Integrated Appliances
- Good Local Schools
- Security Deposit (5 weeks rent): £4269.23
- Council Tax Band E

OVERDALE ROAD

Approximate Gross Internal Area
1354 sq ft / 125.79 sq m

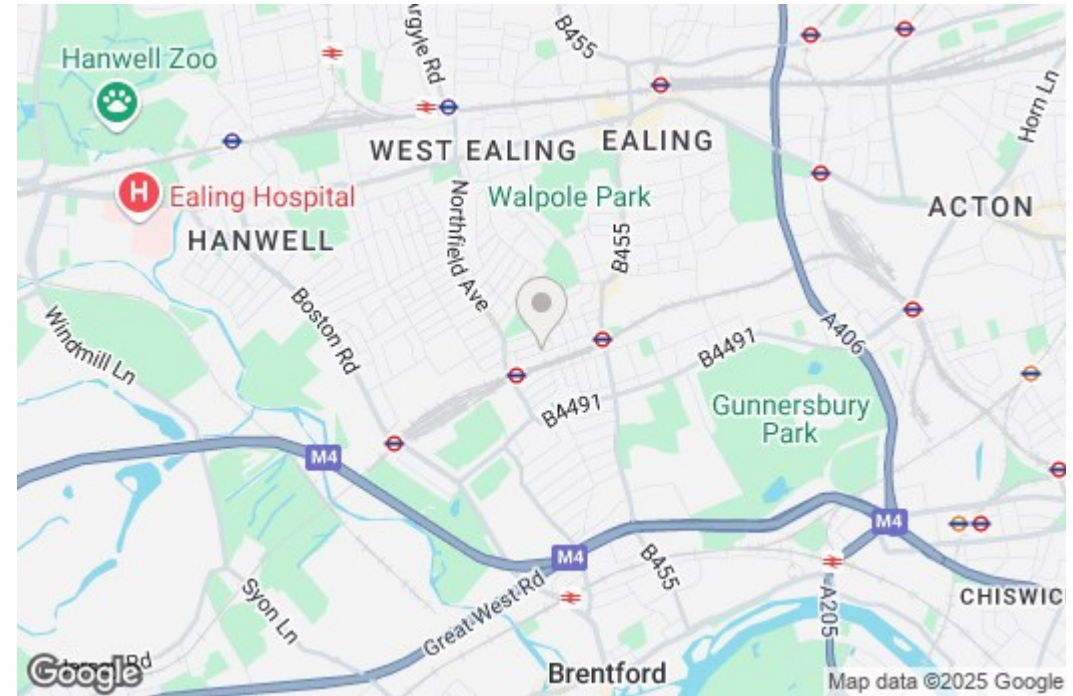
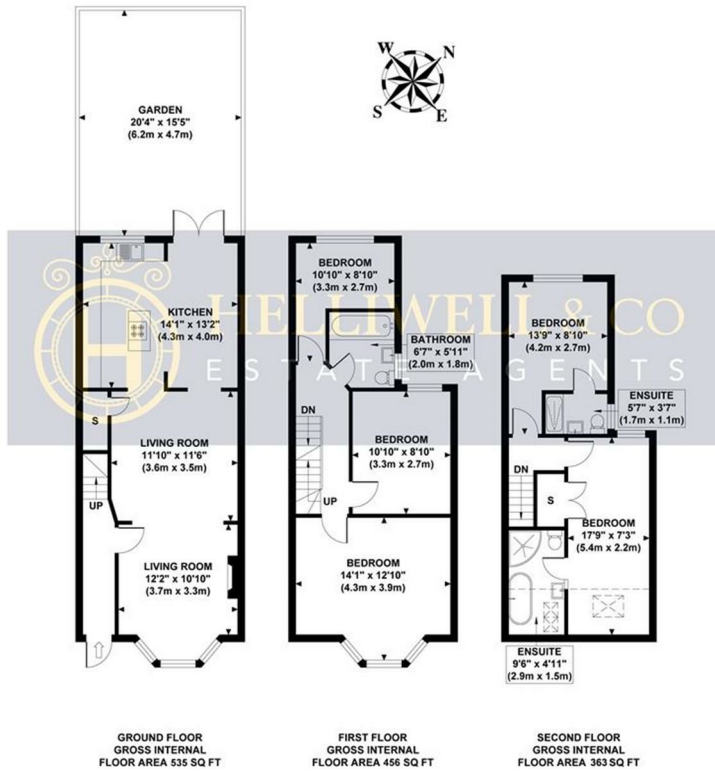

Although every attempt has been made to ensure accuracy, all measurements are approximate and no responsibility is taken for any error, omission, or mid-statement. This floor plan is for illustrative purposes only and not to scale. Measured in accordance to RICS standards.