



HELLIWELL & CO  
ESTATE AGENTS

Sayers Court, Ealing W5  
Guide Price £1,500,000





4 Bedrooms | 2 Receptions | 4 Bathrooms | EPC Current C

Helliwell & Co is proud to present this expansive, Neo-Georgian semi-detached home, set within a private gated development in a prime location, just south of Ealing Broadway, offered to the market chain free.

Through the secure and secluded gated entrance, you are met with the dramatic beauty of the external Georgian-style architecture, in-keeping with the beautiful Olde Ealing surroundings. This immense family home, boasting well over 2500 square feet, is arranged over three floors and briefly comprises; two generous reception rooms, separate modern kitchen, four large double bedrooms, three bathrooms and a fourth WC, beautiful walled private garden, first floor sun terrace and two lower ground patios. The excellent condition and high specification is evident throughout this imposing property, which also benefits from impressive storage, off-street parking for one car plus guest spaces, and an enviable efficiency rating for such a large plot. Additionally there is an option to extend into the loft, subject to any necessary permissions.

Sayer's Court is a highly sought-after and rarely-available development in a desirable pocket of Ealing, with an abundance of boutiques and cafes nearby, as well as easy access to Walpole Park, Lammas Park, a variety of schools which enjoy exemplary reputations, and of course the beating heart of Ealing's centre and its abundance of shops, restaurants, cafes and unparalleled transport links in the form of the Central Line, District Line, GWR and Elizabeth Line.

- Expansive Semi-Detached House
- Four Bedrooms
- Private South Facing Garden
- Secluded Gated Development
- Tenure: Freehold
- Beautiful Neo-Georgian Architecture
- Three Bathrooms and addition cloakroom
- Ample Off-Street Parking
- Prime Olde Ealing Location
- Council Tax Band: G

**SAYERS COURT**

Approximate Gross Internal Area  
2495 sq ft / 231.8 sq m  
Garage Area 110 sq ft / 10.2 sq m  
Total Area 2605 sq ft / 242.0 sq m



FIRST FLOOR  
GROSS INTERNAL  
FLOOR AREA 969 SQ FT

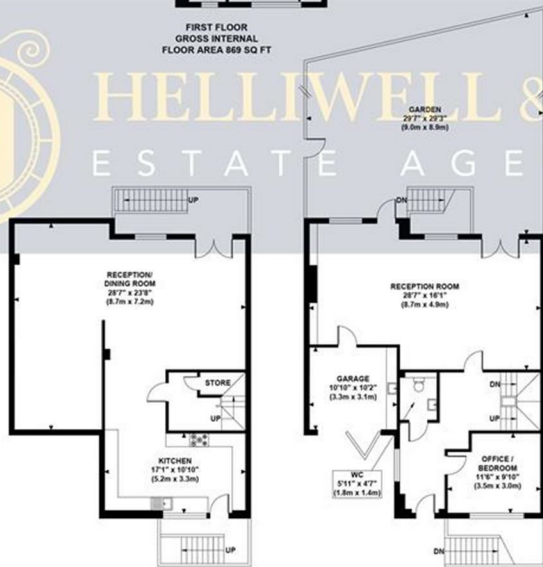

BASEMENT FLOOR  
GROSS INTERNAL  
FLOOR AREA 870 SQ FT

GROUND FLOOR  
GROSS INTERNAL  
FLOOR AREA 756 SQ FT



Although every attempt has been made to ensure accuracy, all measurements are approximate and no responsibility is taken for any error, omission, or mid-statement. This floor plan is for illustrative purposes only and not to scale. Measured in accordance to RICS standards.