



HELLIWELL & CO
ESTATE AGENTS

Park Place, Ealing, W5
£3,500 Per Calendar Month





 2 Bedrooms |  1 Receptions |  2 Bathrooms |  EPC Current B

Helliwell & Co are proud to present this brand new two-bedroom house which is set within a brand new gated development in a sought-after pocket of Olde Ealing.

Located in a quiet yet central pocket in Ealing, a stone's throw away from Ealing Broadway, this newly built house has been constructed to an exceptional standard. Whilst conveniently placed for access transport links of both Ealing Broadway (Central, District, National Rail and Elizabeth Line) and South Ealing (Piccadilly Line) stations, Park Place is set close to Ealing Broadway's bustling shopping centre, offering an array of shops, cafes, pubs, and restaurants. The beautiful open spaces of Walpole Park and Ealing Common are also close by.

A bright, spacious and thoughtfully planned living area leads to a semi-open kitchen and dining area with direct access to a private south-facing courtyard. There are two double bedrooms, all with ample built in storage, one of which has an en-suite shower room. There is a further fully fitted bathroom. Further benefits include underfloor heating, Bosch integrated appliances, Carrera style marble worktops and engineered oak wooden flooring. Additionally there are wireless alarm and video entry systems, allocated off-street parking and bicycle and refuse areas. This secure gated development provides additional privacy, whilst enjoying the benefit of a 10 minute stroll to Ealing Broadway.

- Brand New Gated Development
- Two Double Bedrooms
- EPC Rating B
- High Quality Finish Throughout
- Security Deposit (5 weeks rent): £4,038.46
- Allocated Off Street Parking
- Fully Furnished
- Modern Kitchen and Living Room
- Holding Deposit (1 weeks rent): £805.00
- Long Let (12-24 months+)

PARK PLACE, W5

TOTAL AREA: APPROX. 94.85 SQ. METRES (1021.0 SQ. FEET)

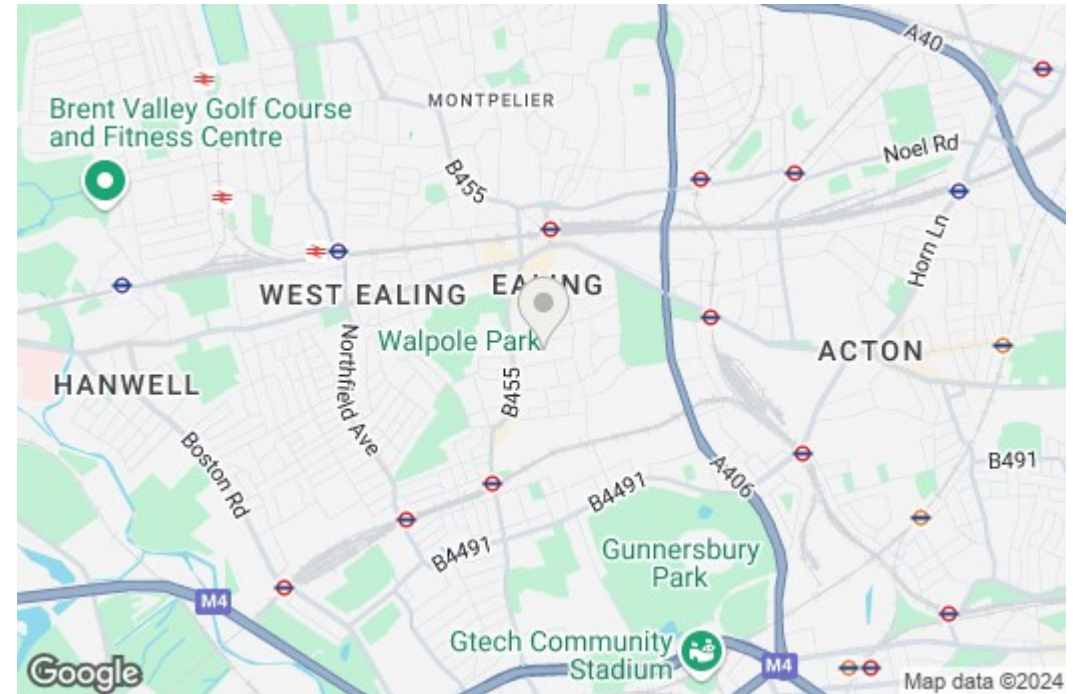
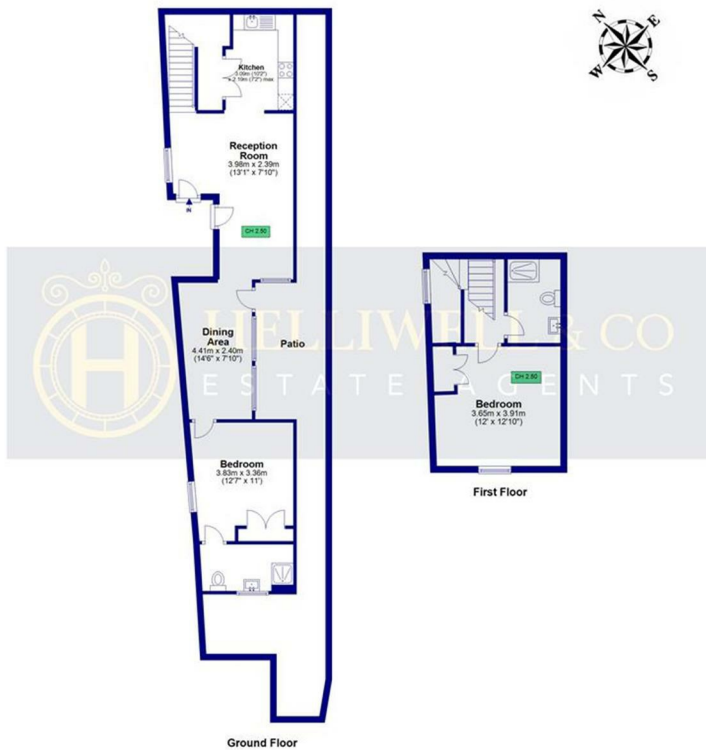

Although every attempt has been made to ensure accuracy, all measurements are approximate and no responsibility is taken for any error, omission, or mid-statement. This floor plan is for illustrative purposes only and not to scale. Measured in accordance to RICS standards