







🛏️ 2 Bedrooms | 🛋️ 1 Receptions | 🚿 2 Bathrooms | 📊 EPC Current B

Helliwell & Co are proud to present this new two-bedroom house which is set within a gated development in the sought-after pocket of Olde Ealing.

A bright, spacious and thoughtfully planned living area leads to a semi-open kitchen and dining area with direct access to a private south-facing courtyard. There are two double bedrooms, all with ample built in storage, one of which has an en-suite shower room. There is a further fully fitted bathroom offering space and convenience. Further benefits include underfloor heating, Bosch integrated appliances, Carrera style marble worktops and engineered oak wooden flooring. Additionally there are wireless alarm and video entry systems, allocated off-street parking and bicycle and refuse areas. This secure gated development provides additional privacy, whilst enjoying the benefit of a 10 minute stroll to Ealing Broadway.

Located a stone's throw away from Ealing Broadway, recently built house has been constructed to an exceptional standard. Whilst conveniently placed for access transport links of both Ealing Broadway (Central, District, National Rail and Elizabeth Line) and South Ealing (Piccadilly Line) stations, Park Place is set close to Ealing Broadway's bustling shopping centre, offering an array of shops, cafes, pubs, and restaurants. The beautiful open spaces of Walpole Park and Ealing Common are also close by.

- Gated Development
- Two Double Bedrooms
- Modern Kitchen and Living Room
- Holding Deposit (1 weeks rent): £784.00
- Long Let (12-24 months+)
- Allocated Off Street Parking
- Two Bathrooms (One En Suite)
- High Quality Finish Throughout
- Security Deposit (5 weeks rent): £3,923.08
- Council Tax Band: E

**PARK PLACE, W5**

TOTAL AREA: APPROX. 94.85 SQ. METRES (1021.0 SQ. FEET)

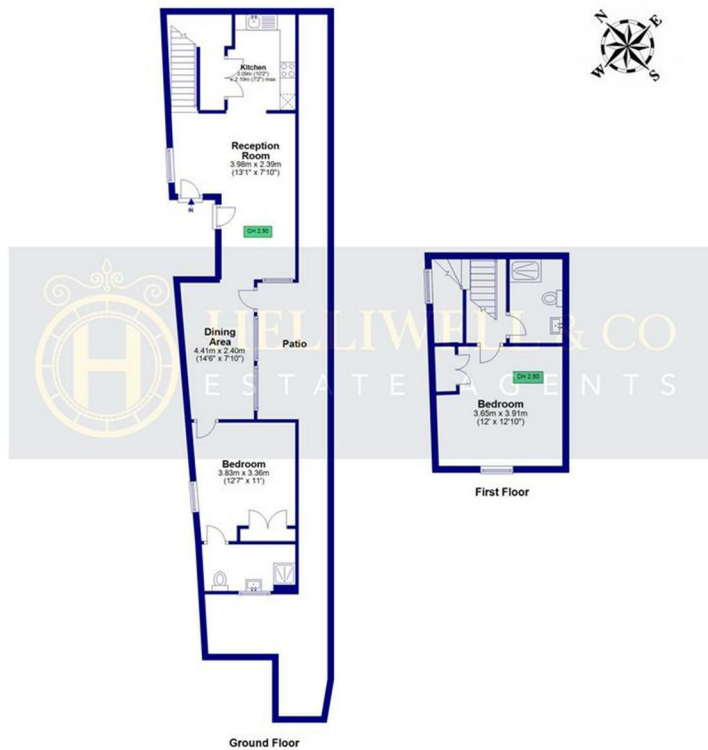

Although every attempt has been made to ensure accuracy,  
all measurements are approximate and no responsibility is taken for any error, omission, or mid-statement.  
This floor plan is for illustrative purposes only and not to scale. Measured in accordance to RICS standards

