



HELLIWELL & CO
ESTATE AGENTS

Maytree Gardens, Ealing W5
Guide Price £520,000





🛏️ 2 Bedrooms | 🛋️ 1 Receptions | 🚿 1 Bathrooms | 📊 EPC Current C

Helliwell & Co are proud to present this two-bedroom apartment with staggering views and offered to the market with no onward chain.

Set on the top floor of a well-maintained, purpose-built apartment, this unique two-bedroom apartment boasts stunning views all across South Ealing. Consisting of circa 660sqft, the property boasts two double bedrooms, both with built-in ample storage units and the master benefits from access to a south-facing private balcony. Leading to the living room which has smart wooden flooring throughout and plenty of space for dining. The separate fitted kitchen boasts clever storage units that make full use of the space. It also has integrated appliances, including a larger-than-average gas cooker. The bathroom is fully tiled and comes with a large rainfall shower. Further benefits include water rates included within the service charges, a large loft space, its own private entrance, allocated parking, a lift, communal roof terraces, air conditioning, double glazing, gas central heating and no onward chain.



Set back from South Ealing Road, Maytree is a sought-after development, nestled perfectly between South Ealing (Piccadilly Line) and Ealing Broadway (Elizabeth Line, District Line, Central Line & GWR), with an abundance of shops, restaurants and bars nearby. Lammas Park is a stone's throw away, perfect for picnics in the summer and brisk walks in the winter.

- Purpose Built
- Two Double Bedrooms
- Stunning Views
- Lift
- South Facing Balcony
- Allocated Parking
- Tenure: Leasehold (96 years)
- Service Charge: £4,172.42pa
- Ground Rent: £350.00pa
- Council Tax Band: E

MAYTREE GARDENS

Approximate Gross Internal Area
660 sq ft / 61.3 sq m

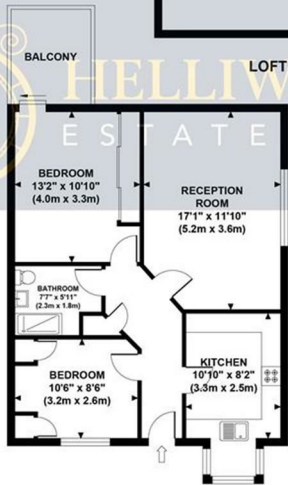
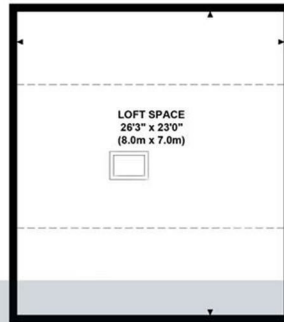

**GROSS INTERNAL
FLOOR AREA 660 SQ FT**

Although every attempt has been made to ensure accuracy,
all measurements are approximate and no responsibility is taken for any error, omission, or mid-statement.
This floor plan is for illustrative purposes only and not to scale. Measured in accordance to RICS standards.

