



HELLIWELL & CO
ESTATE AGENTS

Little Ealing Lane, Ealing, W5
£1,675 Per Calendar Month





 1 Bedrooms
 |
  1 Receptions
 |
  1 Bathrooms
 |
  EPC Current D

Helliwell & Co. are delighted to present this bright and spacious first floor flat which is placed within this charming historic detached building and is offered to the market furnished. With period charm and character, the property has a large reception, a double bedroom, a kitchen featuring integrated appliances and ample storage space and a bathroom, equipped with a bathtub and overhead shower. The property has been recently redecorated throughout and has had brand new flooring installed. Further benefits include high ceilings, gas central heating, communal gardens, off street parking and a well maintained communal entrance / hallway. Available 22/07/2025.

Little Ealing Lane is ideally located for access to both South Ealing (Piccadilly line) and Northfields (Piccadilly line) tube stations, as well as multiple local shops, cafes and restaurants. The beautiful open spaces of Lammas and Gunnersbury Parks are also close by.

- Historic Detached Building
- First Floor Flat
- Large Reception
- Holding Deposit: £386.00 (1 weeks rent)
- Council Tax Band: D
- Period Charm & Character
- Double Bedroom
- Communal Gardens
- Security Deposit: £1932.69 (5 weeks rent)
- Long Let (12-24 months+)

ROCHESTER HOUSE

Approximate Gross Internal Area

483 sq ft / 44.90 sq m

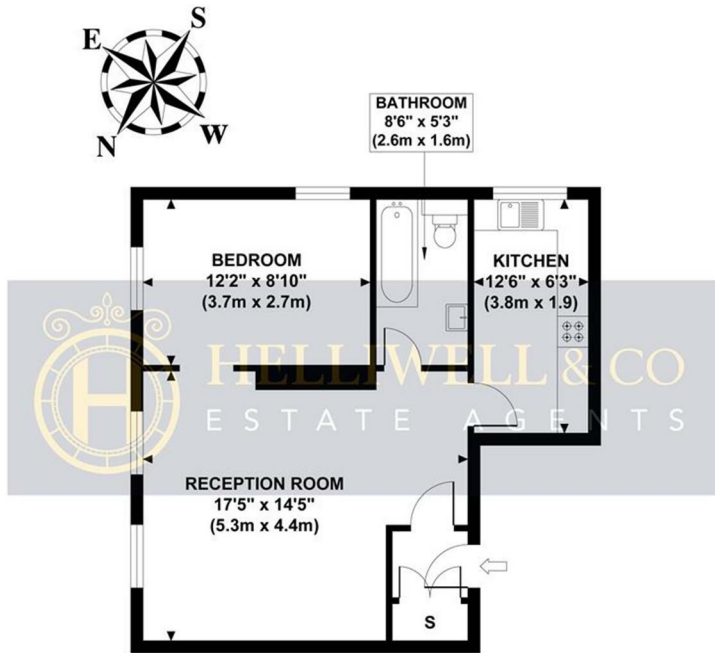

**FIRST FLOOR
GROSS INTERNAL
FLOOR AREA 483 SQ FT**

Although every attempt has been made to ensure accuracy,
all measurements are approximate and no responsibility is taken for any error, omission, or mid-statement.
This floor plan is for illustrative purposes only and not to scale. Measured in accordance to RICS standards.

