







🛏️ 2 Bedrooms | 🛋️ 1 Receptions | 🚿 2 Bathrooms | 📊 EPC Current D

Helliwell & Co. are proud to present this top floor, two-bedroom flat with a modern and luxurious interior. The property has a spacious, bright reception room that boasts a, electric fireplace mounted on a mock marble backsplash, a modern chandelier, arctic grey wood flooring, and three double-glazed windows providing great lighting and insulation throughout the day. The open plan kitchen is fitted with a gas hob and integrated appliances - including a large fridge freezer - as well as ample cabinet storage space and a generous sized worktop. The bedrooms are lustrous, homely and spacious, one of which includes a private en-suite with an overhead shower and a smart mirror. The main bathroom features a sleek, modern bathtub with a rainfall shower, beautiful tiling to match, dark grey floor tiles, a smart mirror, chrome towel rail and double-glazed windows for additional lighting. It includes an alarm and entry phone system for maximum security.

Located in the heart of Ealing, Windsor Road is a short walk from Ealing Broadway (Piccadilly & District Lines, National Rail), an array of local cafes, restaurants and beautiful parks in the surrounding area. The North Circular offers convenient routes for travel, while the proximity to Uxbridge Road also allows easy access into Central London.

- Top Floor Flat
- Two Double Bedrooms
- Two Bathrooms (One En Suite)
- Holding Deposit: £530.00
- Long Term: 12-24 months+
- Modern & Trendy Interior
- Open Plan Living
- Communal Gardens
- Security Deposit: £2,653.85
- Council Tax Band: D

WINDSOR ROAD

Approximate Gross Internal Area
707 sq ft / 65.68 sq m

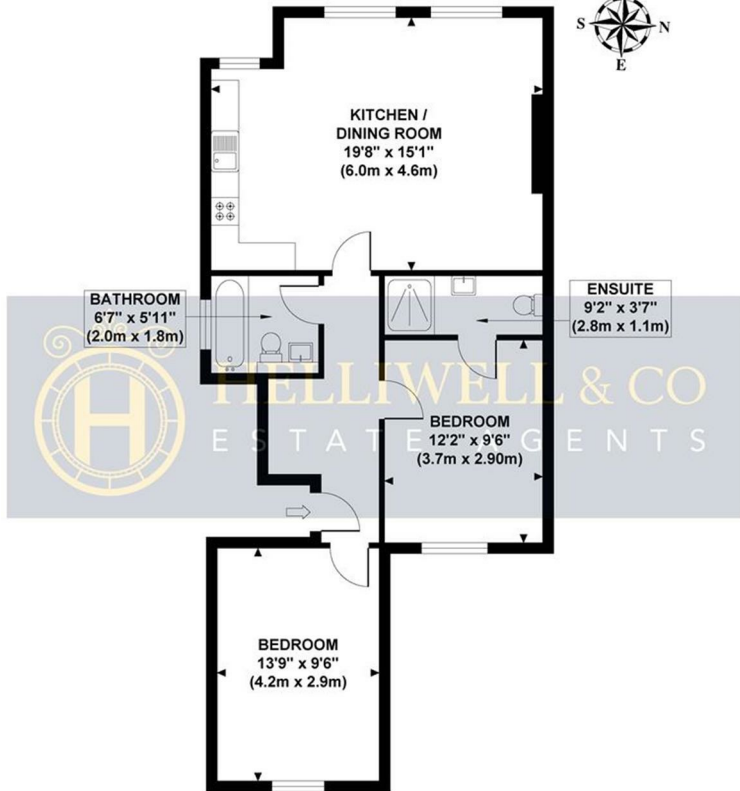

**SECOND FLOOR
GROSS INTERNAL
FLOOR AREA 707 SQ FT**



Although every attempt has been made to ensure accuracy, all measurements are approximate and no responsibility is taken for any error, omission, or mid-statement. This floor plan is for illustrative purposes only and not to scale. Measured in accordance to RICS standards.