







🛏 5 Bedrooms | 🛋 1 Receptions | 🚿 2 Bathrooms | 📊 EPC Current D

Helliwell & Co. are delighted to present this end of terrace house, offered to the market furnished and available for immediate occupation. The property which has been fully redecorated throughout, has a large reception room, a fully equipped kitchen, five double bedrooms and two bathrooms. Offering ample storage space and gas central heating, the property is ideal for a group of professional sharers.

Placed on a popular residential road in Northfields, the property is ideally located for access to West Ealing (Elizabeth line), Northfields tube station (Piccadilly line) and the fantastic array of local shops, cafes and restaurants the area has to offer. Ealing Broadways bustling shopping centre and station (Central, District, Mainline, Elizabeth Line), are also within easy reach, as well as the picturesque open spaces of both Elthorne and Lammas Parks.

- Ideal for Professional Sharers
- Five Double Bedrooms
- Two Bathrooms
- Holding Deposit (1 week rent): £807.00
- Ealing Council Tax Band: E
- Recently Redecorated Throughout
- Separate Reception Room
- Fantastic Location
- Security Deposit (5 weeks rent): £3,461.53
- Long Let (12 months+)

GLENFIELD ROAD

Approximate Gross Internal Area
1197 sq ft / 111.2 sq m

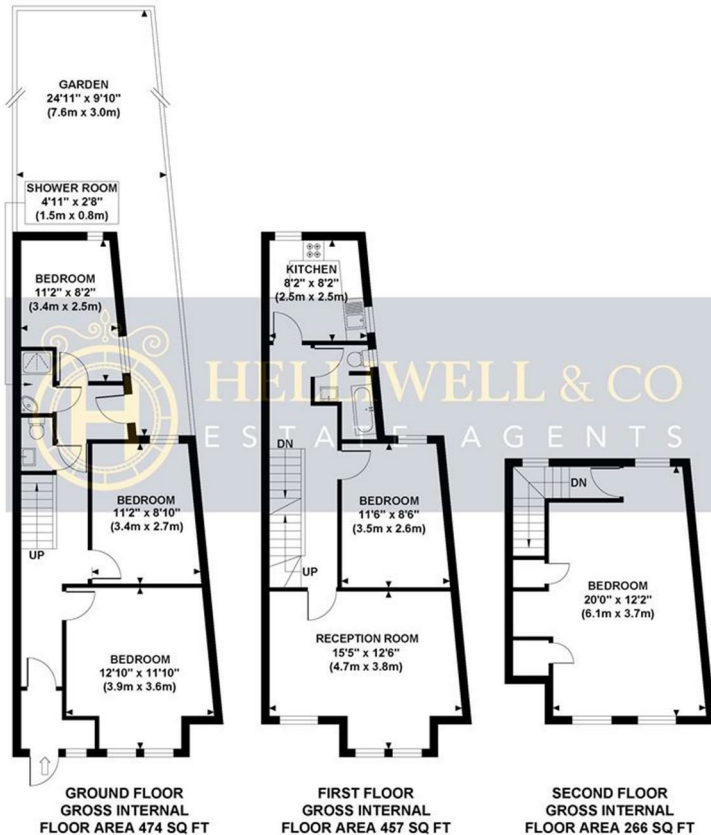

Although every attempt has been made to ensure accuracy,
all measurements are approximate and no responsibility is taken for any error, omission, or mid-statement.
This floor plan is for illustrative purposes only and not to scale. Measured in accordance to RICS standards.

