







 2 Bedrooms |  1 Receptions |  1 Bathrooms |  EPC Current D

Helliwell & Co. are delighted to present this charming flat located on Elmore Close in the vibrant area of Wembley, HA0. This bright and spacious flat, offers a comfortable living space, perfect for those seeking a convenient and modern lifestyle. Spanning approximately 600 square feet, the flat features a well-proportioned reception room that provides an inviting atmosphere for relaxation and entertaining, two bedrooms (one double, one single), a fully fitted separate kitchen, and a good sized bathroom.

One of the notable advantages of this property is the availability of parking, a valuable asset in this bustling area. The flat is situated in a friendly neighbourhood, with easy access to local amenities, shops, and public transport links, making it an ideal choice for those who commute or enjoy exploring the wider London area.

- Purpose Built Development
- Two Bedrooms
- Separate Fully Fitted Kitchen
- Holding Deposit (1 weeks rent): £432.00
- Council Tax Band D
- First Floor Flat
- Large Lounge
- Off Street Parking
- Security Deposit (5 weeks rent): £2,163.46
- Long Let (12-24 months+)

SUNDEW COURT

Approximate Gross Internal Area
600 sq ft / 55.7 sq m

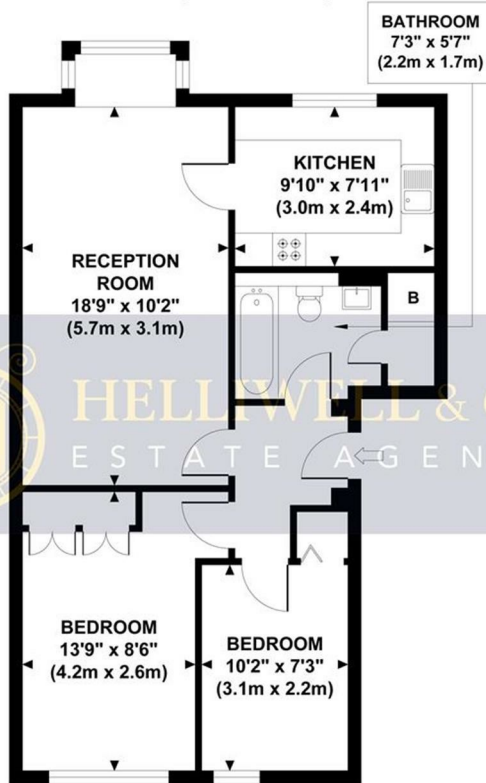

**FIRST FLOOR
GROSS INTERNAL
FLOOR AREA 600 SQ FT**

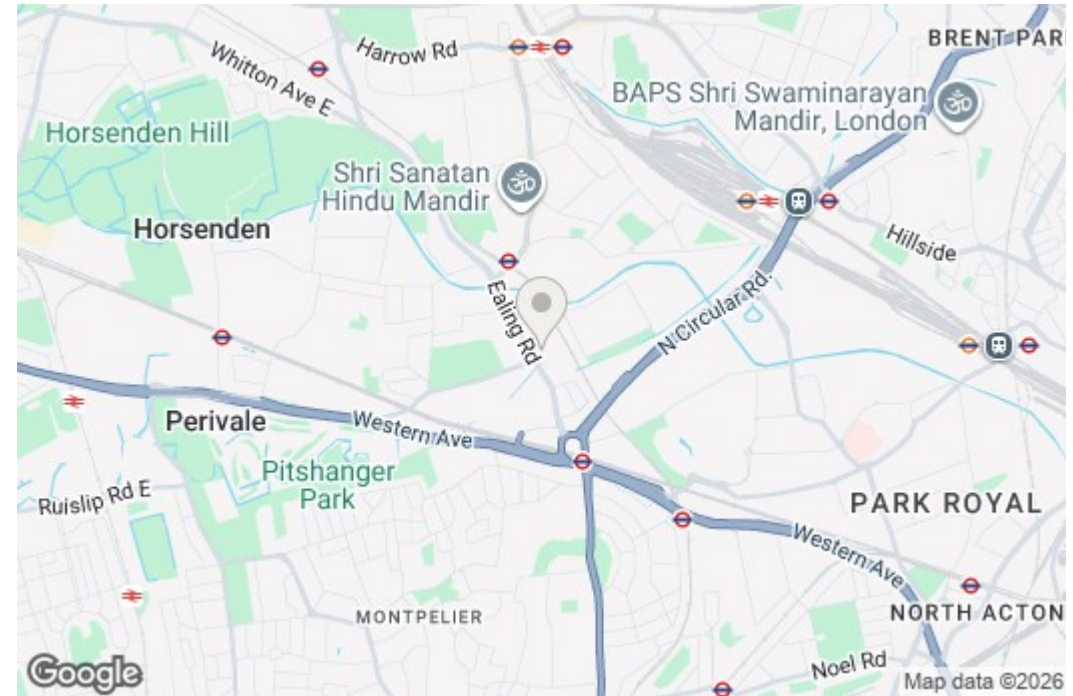

Although every attempt has been made to ensure accuracy, all measurements are approximate and no responsibility is taken for any error, omission, or mis-statement. This floor plan is for illustrative purposes only and not to scale. Measured in accordance to RICS standards.